



### 3 Overview of Types and Type Designation

#### 3.1 Product variants and options of the gear units

Below an overview of type designations for R, F, K, S, and W gear units and their options.

##### *Helical gear units*

Designation	
RX..	Single-stage foot-mounted type
RXF..	Single-stage B5 flange-mounted type
R..	Foot-mounted
R..F	Foot and B5-flange mounted type
RF..	B5 flange-mounted
RZ..	B14 flange-mounted
RM..	B5 flange-mounted type with extended bearing hub

##### *Parallel shaft helical gear units*

Designation	
F..	Foot-mounted
FA..B	Foot-mounted, hollow shaft
FH..B	Foot-mounted, hollow shaft with shrink disk
FV..B	Foot-mounted, hollow shaft with splined hollow shaft to DIN 5480
FF..	B5 flange-mounted
FAF..	B5 flange-mounted type, hollow shaft
FHF..	B5 flange-mounted type and hollow shaft with shrink disk
FVF..	B5 flange-mounted type and hollow shaft with splined hollow shaft to DIN 5480
FA..	Hollow shaft
FH..	Hollow shaft with shrink disk
FT..	Hollow shaft with TorqLOC® hollow shaft mounting system
FV..	Hollow shaft with splining to DIN 5480
FAZ..	B14 flange-mounted type, hollow shaft
FHZ..	B14 flange-mounted type and hollow shaft with shrink disk
FVZ..	B14 flange-mounted type and hollow shaft with splined hollow shaft to DIN 5480



## Helical-bevel gear units

Designation	
K..	Foot-mounted
KA..B	Foot-mounted, hollow shaft
KH..B	Foot-mounted, hollow shaft with shrink disk
KV..B	Foot-mounted, hollow shaft with splined hollow shaft to DIN 5480
KF..	B5 flange-mounted
KAF..	B5 flange-mounted type and hollow shaft
KHF..	B5 flange-mounted type and hollow shaft with shrink disk
KVF..	B5 flange-mounted type and hollow shaft with splined hollow shaft to DIN 5480
KA..	Hollow shaft
KH..	Hollow shaft with shrink disk
KT..	Hollow shaft with TorqLOC® hollow shaft mounting system
KV..	Hollow shaft with splining to DIN 5480
KAZ..	B14 flange-mounted type and hollow shaft
KHZ..	B14 flange-mounted type and hollow shaft with shrink disk
KVZ..	B14 flange-mounted type and hollow shaft with splined hollow shaft to DIN 5480

## Helical-worm gear units

Designation	
S..	Foot-mounted
SF..	B5 flange-mounted
SAF..	B5 flange-mounted and hollow shaft
SHF..	B5 flange-mounted and hollow shaft with shrink disk
SA..	Hollow shaft
SH..	Hollow shaft with shrink disk
ST..	Hollow shaft with TorqLOC® hollow shaft mounting system
SAZ..	B14 flange-mounted and hollow shaft
SHZ..	B14 flange-mounted and hollow shaft with shrink disk



## Overview of Types and Type Designation

### Product variants and options of the gear units

#### **SPIROPLAN® gear units**

Designation	
W..	Foot-mounted
WF..	Flange-mounted
WAF..	Flange-mounted type, hollow shaft
WA..	Hollow shaft
WA..B	Foot-mounted, hollow shaft
WH..B	Foot-mounted, hollow shaft with shrink disk
WHF..	Flange-mounted, hollow shaft with shrink disk
WH..	Hollow shaft with shrink disk
WT..	Hollow shaft with TorqLOC® hollow shaft mounting system

#### **Options**

R, F and K gear units:

Designation	
/R	Reduced backlash

K, S and W gear units:

Designation	
/T	With torque arm

F gear units:

Designation	
/G	With rubber buffer

#### **Condition monitoring**

Designation	Option
/DUO	Diagnostic Unit Oil = Oil aging sensor
/DUV	Diagnostic Unit Vibration = Vibration sensor



### 3.2 Gearmotor variants

	<b>INFORMATION</b>
	<p>The variants described in this chapter refer to DRL gearmotors from SEW-EURODRIVE.</p> <p>These variants also apply to gear units without motors.</p>

#### Helical gearmotors

The following types of helical gearmotors are available:

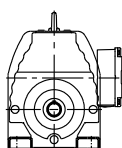
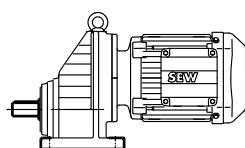

**RX..DRL..**  
Foot-mounted single stage helical gear unit

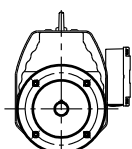
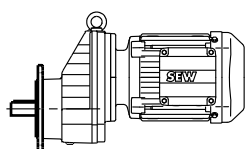

**RXF..DRL..**  
Single-stage helical gearmotor in B5 flange-mounted design

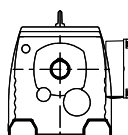
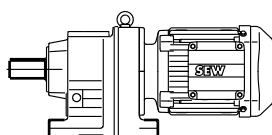

**R..DRL..**  
Foot-mounted helical gearmotor

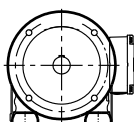
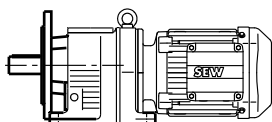

**R..F DRL..**  
Foot and B5 flange-mounted helical gearmotor

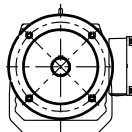
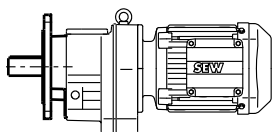

**RF..DRL..**  
B5 flange-mounted helical gearmotor

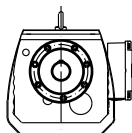
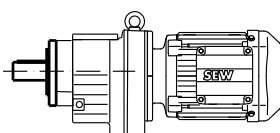

**RZ..DRL..**  
B14 flange-mounted helical gearmotor

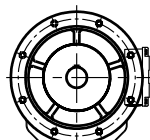
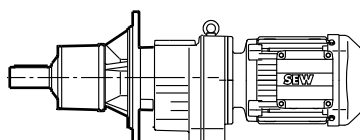

**RM..DRL..**  
B5 flange-mounted helical gearmotor with extended bearing hub

60382AXX



#### Parallel shaft helical gearmotors

The following types of parallel shaft helical gearmotors are available:

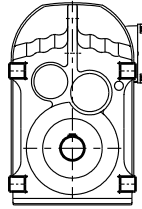
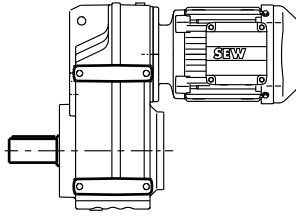

#### **F..DRL..**

Foot-mounted parallel shaft helical gearmotor

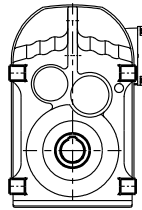
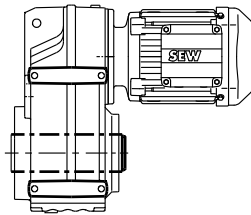

#### **FA..B DRL..**

Foot-mounted parallel shaft helical gearmotor with hollow shaft

#### **FV..B DRL..**

Foot-mounted parallel shaft gearmotor with hollow shaft and splining according to DIN 5480

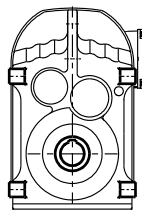
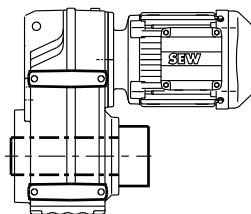

#### **FH..B DRL..**

Foot-mounted parallel shaft helical gearmotor with hollow shaft and shrink disk

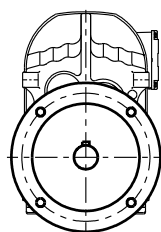
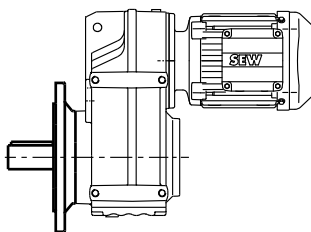

#### **FF..DRL..**

B5 flange-mounted parallel shaft helical gearmotor

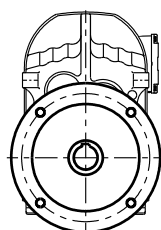
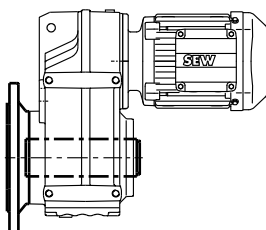

#### **FAF..DRL..**

B5 flange-mounted parallel shaft helical gearmotor with hollow shaft

#### **FVF..DRL..**

B5 flange-mounted parallel shaft helical gearmotor in B14 with hollow shaft and splining according to DIN 5480

60383AXX

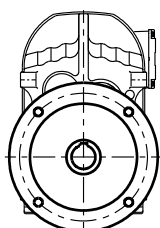
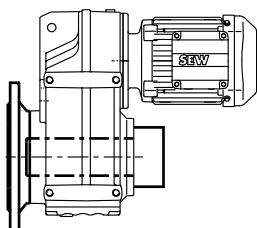

### FHF..DRL..

B5 flange-mounted parallel shaft helical gearmotor with hollow shaft and shrink disk

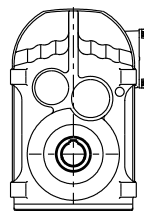
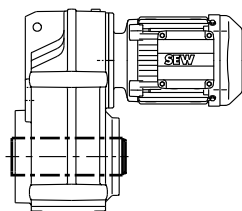

### FA..DRL..

Parallel shaft helical gearmotor with hollow shaft

### FV..DRL..

Parallel shaft helical gearmotor with hollow shaft and splining according to DIN 5480

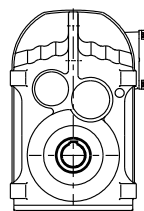
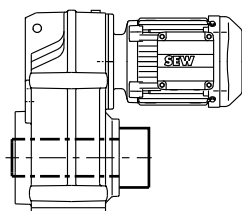

### FH..DRL..

Parallel shaft helical gearmotor with hollow shaft and shrink disk

### FT..DRL..

Parallel shaft helical gearmotor with hollow shaft and TorqLOC® hollow shaft mounting system

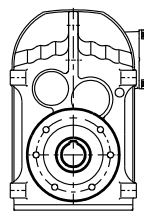
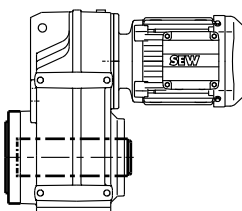

### FAZ..DRL..

B14 flange-mounted parallel shaft helical gearmotor with hollow shaft

### FVZ..DRL..

B14 flange-mounted parallel shaft helical gearmotor in B14 with hollow shaft and splining according to DIN 5480

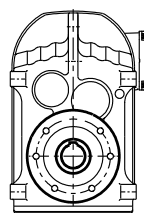
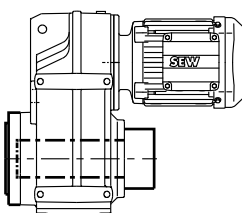

### FHZ..DRL..

B14 flange-mounted parallel shaft helical gearmotor with hollow shaft and shrink disk

60396AXX



## Overview of Types and Type Designation

### Gearmotor variants

#### Helical-bevel gearmotors

The following types of helical-bevel gearmotors are available:

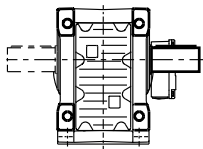
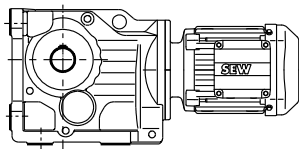

#### **K..DRL..**

Foot-mounted helical-bevel gearmotor

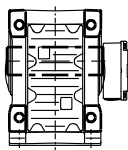
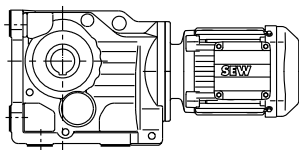

#### **KA..B DRL..**

Foot-mounted helical-bevel gearmotor with hollow shaft

#### **KV..B DRL..**

Foot-mounted helical-bevel gearmotor with hollow shaft and splining according to DIN 5480

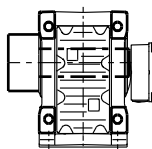
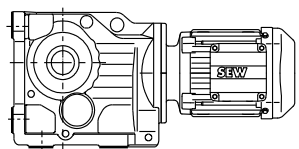

#### **KH..B DRL..**

Foot-mounted helical-bevel gearmotor with hollow shaft and shrink disk

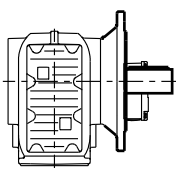
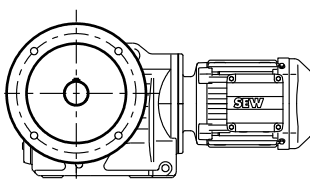

#### **KF..DRL..**

B5 flange-mounted helical-bevel gearmotor

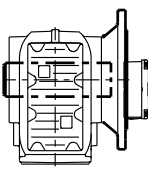
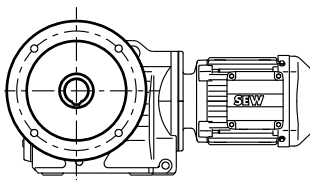

#### **KAF..DRL..**

B5 flange-mounted helical-bevel gearmotor with hollow shaft

#### **KVF..DRL..**

B5 flange-mounted helical-bevel gearmotor with hollow shaft and splined hollow shaft to DIN 5480

60397AXX

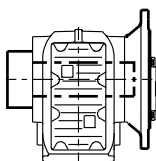
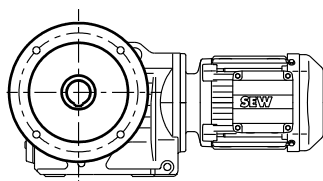

### **KHF..DRL..**

B5 flange-mounted helical-bevel gearmotor with hollow shaft and shrink disk

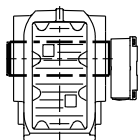
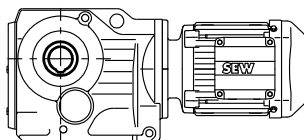

### **KA..DRL..**

Helical-bevel gearmotor with hollow shaft

### **KV..DRL..**

Helical-bevel gearmotor with hollow shaft and splined hollow shaft to DIN 5480

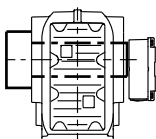
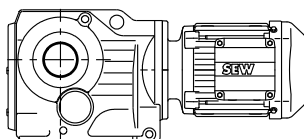

### **KH..DRL..**

Helical-bevel gearmotor with hollow shaft and shrink disk

### **KT..DRL..**

Helical-bevel gearmotor with hollow shaft and TorqLOC<sup>®</sup> hollow shaft mounting system

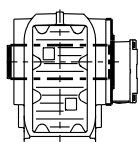
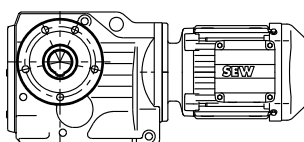

### **KAZ..DRL..**

B14 flange-mounted helical-bevel gearmotor with hollow shaft

### **KVZ..DRL..**

B14 flange-mounted helical-bevel gearmotor with hollow shaft and splined hollow shaft to DIN 5480

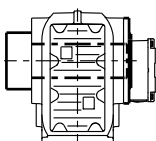
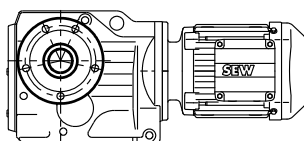

### **KHZ..DRL..**

B14 flange-mounted helical-bevel gearmotor with hollow shaft and shrink disk

60398AXX





## Overview of Types and Type Designation

### Gearmotor variants

#### Helical-worm gearmotors

The following types of helical-worm gearmotors are available:

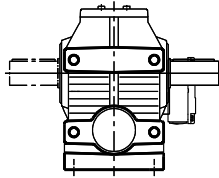
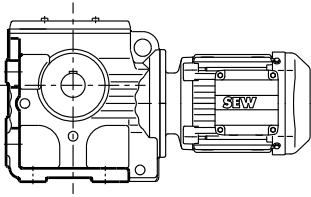

**S..DRL..**  
Foot-mounted helical-worm gearmotor

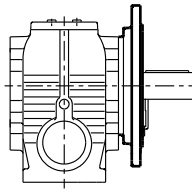
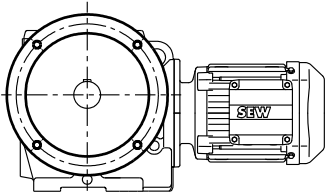

**SF..DRL..**  
B5 flange-mounted helical-worm gearmotor

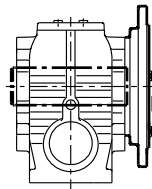
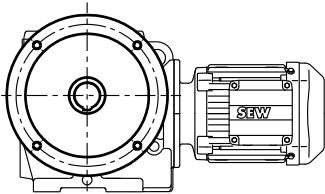

**SAF..DRL..**  
B5 flange-mounted helical-worm gearmotor with hollow shaft

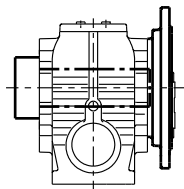
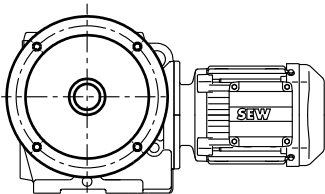

**SHF..DRL..**  
B5 flange-mounted helical-worm gearmotor with hollow shaft and shrink disk

60399AXX

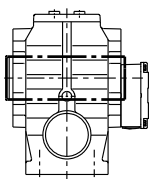
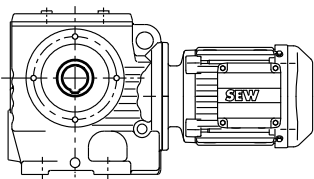

### SA..DRL..

Helical-worm gearmotor with hollow shaft

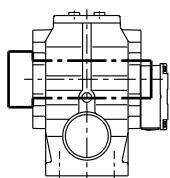
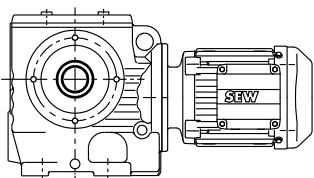

### SH..DRL..

Helical-worm gearmotor with hollow shaft and shrink disk

### ST..DRL..

Helical-worm gearmotor with hollow shaft and TorqLOC® hollow shaft mounting system

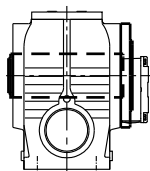
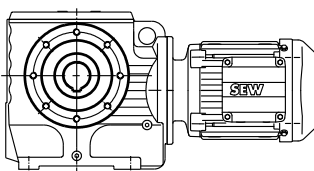

### SAZ..DRL..

B14 flange-mounted helical-worm gearmotor with hollow shaft

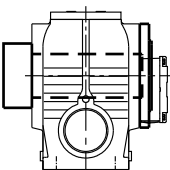
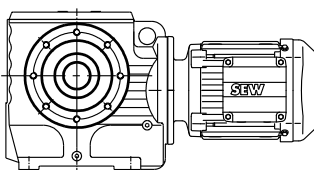

### SHZ..DRL..

B14 flange-mounted helical-worm gearmotor with hollow shaft and shrink disk

60400AXX



## Overview of Types and Type Designation

### Gearmotor variants

#### **SPIROPLAN® gearmotors**

The following types of SPIROPLAN® gearmotors are available:

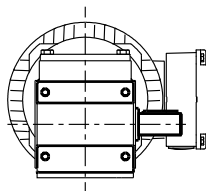
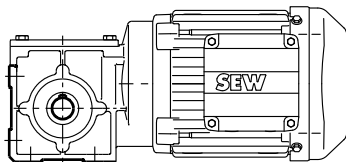

**W..DRL..**  
Foot-mounted SPIROPLAN® gearmotor

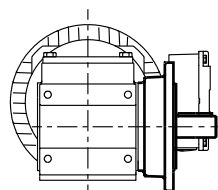
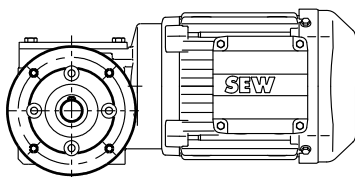

**WF..DRL..**  
Flange-mounted SPIROPLAN® gearmotor

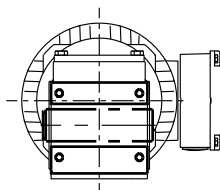
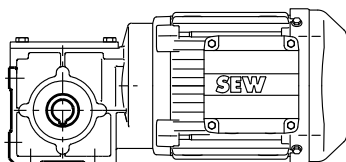

**WA..DRL..**  
SPIROPLAN® gearmotor with hollow shaft

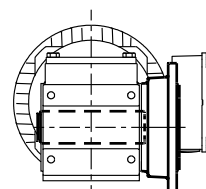
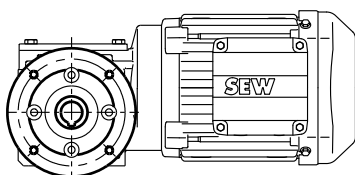

**WAF..DRL..**  
Flange-mounted SPIROPLAN® gearmotor with hollow shaft

60401AXX

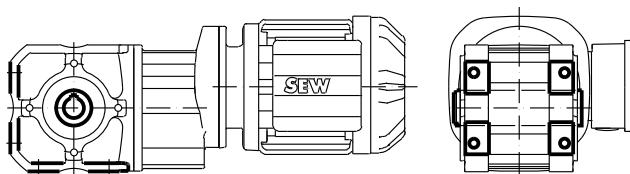

### WA..B DRL..

Foot-mounted SPIROPLAN® gearmotor with hollow shaft

3

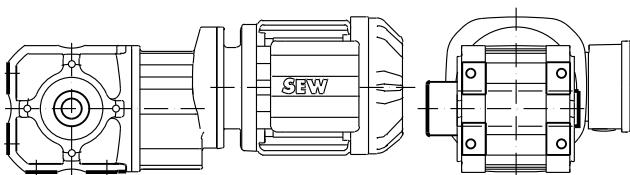

### WH..B DRL..

Foot-mounted SPIROPLAN® gearmotor with hollow shaft and shrink disk

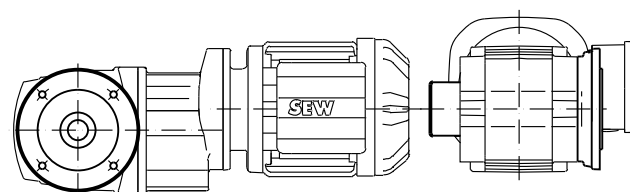

### WHF.. DRL..

Flange-mounted SPIROPLAN® gearmotor with hollow shaft and shrink disk

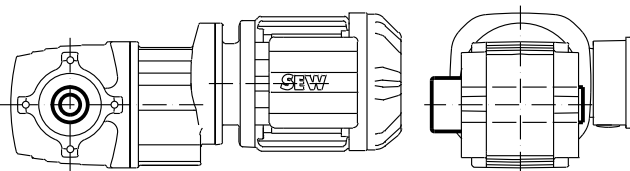

### WH.. DRL..

SPIROPLAN® gearmotor with hollow shaft and shrink disk

### WT.. DRL..

SPIROPLAN® gearmotor with hollow shaft and TorqLOC®

62643AXX



### 3.3 Motor variants and options

Motor variant		Type designation of the motor variant																			
Condition monitoring																					
Brake monitoring			/DUB	/DUV																	
Ventilation																					
Low-noise fan guard	-		/LN	* in preparation																	
Fan guard	-		/C									/LF									
Fan	-		/Z									/AL									
Forced cooling fan	-		/V									/VE*									
Connection options																					
Connection options	-		/IS	/AB..	/AC..	/AD..	/AK..	/AM..	/AS..	/KCC	/KC1										
Encoder																					
Built-in encoder	-				/EI7C	/EI76	/EI72	/EI71													
Encoder	-				/ES7.	/EG7.	/EV7.	/AS7.	/AG7.	/XV..											
Explosion-proof motors																					
Explosion protection	-		/3GD*	* in preparation																	
Temperature sensor/temperature detection																					
Thermal motor protection	-		/TF	/TH																	
Temperature detection	-		/KT	/PT																	
Output variants																					
Output variant	/FF		/FG	/FM	/FI*	/FT	/FC	/FE*	/FY*	/FL	/FK*	*= Shaft height									
Mechanical attachments																					
Backstop	-		/RS																		
Manual brake release	-		HF									HR									
Brake	-		BE05									BE1	BE2	BE5	BE11	BE20	BE30	BE32			
Asynchronous servomotor																					
Number of poles	4																				
Length	S											M	L	MC	LC						
Size	100											71	80	90	100	112	132	160	180	200	225
Type designation	L																				
Series	DR																				





### 3.5 Overview of servo gearmotors

#### Axially parallel gear units

Gear unit type For details, refer to			RX.. page 132	R.. page 156	F.. page 245
<b>Technical data</b>					
Peak torque	M <sub>apk</sub>	Nm	90 - 690	51 - 21800	130 - 18000
Max. continuous torque	M <sub>amax</sub>	Nm	63 - 460	50 - 18000	87 - 18000
Max. input speed	n <sub>epk</sub>	rpm	Up to 4500	Up to 4500	Up to 4500
Peak overhung load	F <sub>rapk</sub>	N	3940 - 30000	1500 - 120000	4500 - 120000
Gear ratio range	i		1.3 - 6.63	3.21 - 229.71	4.16 - 267.43
Option with reduced backlash	/R		x	x	x
Option with minimized backlash	/M		-	-	-
<b>Mechanical data</b>					
Hollow shaft			-	-	x
Flange-mounting			x	x	x
Foot-mounting			x	x	-
Flange block			-	-	-
B5 flange			x	x	x
B14 flange			-	x	x

#### Right-angle gear units

Gear unit type For details, refer to			K.. page 344	S.. page 436	W.7 page 464
<b>Technical data</b>					
Peak torque	M <sub>apk</sub>	Nm	187 - 55600	48 - 655	84 - 215
Max. continuous torque	M <sub>amax</sub>	Nm	125 - 50000	32 - 480	70 - 180
Max. input speed	n <sub>epk</sub>	rpm	4500	4500	4500
Peak overhung load	F <sub>rapk</sub>	N	5140 - 190000	3000 - 9740	1490 - 6990
Gear ratio range	i		3.98 - 179.86	3.97 - 75.06	3.2 - 74.98
Option with reduced backlash	/R		x	x	-
Option with minimized backlash	/M		-	-	-
<b>Mechanical data</b>					
Hollow shaft			x	x	x
Flange-mounting			x	x	x
Foot-mounting			x	x	x
Flange block			-	-	-
B5 flange			x	x	x
B14 flange			x	x	-

For information on all available options and variants, refer to page 22 et seq.