



SEW
EURODRIVE

Addendum to the Operating Instructions



CMS..50 – 71, CMSM..50 – 71 Electric Cylinders
Cardanic Mounting
KD, KDD, KDC, FKDC



1 Cardan joint assembly

INFORMATION



Observe the following notes when installing the cardan joint:

- Observe the safety and warning instructions in the applicable "CMS..50 – 71 Electric Cylinders" operating instructions.
- The pivoting angle of the cardan joint to the electric cylinder must not exceed $\pm 3^\circ$.

⚠ WARNING



During assembly, operation or disassembly of the electric cylinder, there is a risk of crushing injuries of hands or body parts near the cardan joint parts.

Serious injuries.

- Do not touch the cardan joint parts during operation.
- Keep sufficient distance from the drive.
- Install protection devices in the plant structure.

1.1 KD, KKD design (mounted to B-side)

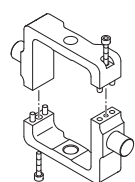
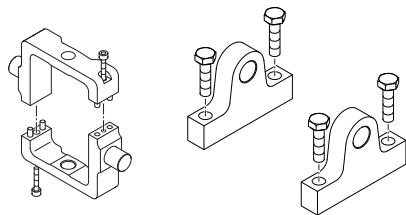
Design	Figure
KD Cardan joint	 24005237003
KKD Cardan joint including cardan mounting kit	 24005243915

Cardan joint assembly

KD, KKD design (mounted to B-side)

1.1.1 Mounting kit

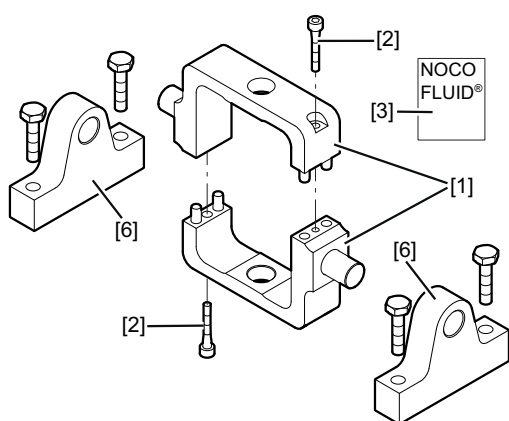

22858350347

- 1 × cardan joint [1]
- 2 × cap screws [2]
- 1 × NOCO® fluid [3]
- 2 × mounting plates (KKD only) [6]

1.1.2 Assembly



⚠ WARNING

Uncontrolled oscillatory and rotary movements may occur around the cardan joint axes of the electric cylinder during assembly and disassembly of the electric cylinder.

Serious injuries.

- Secure the electric cylinder against uncontrolled oscillatory movement.
- Do not use the motor connection cables to limit movement.
- Do not strain the motor connection cables with tensile forces.

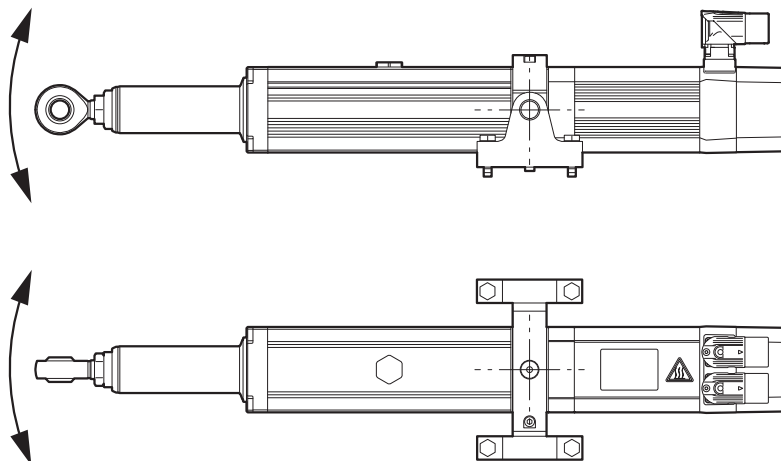

23482065675

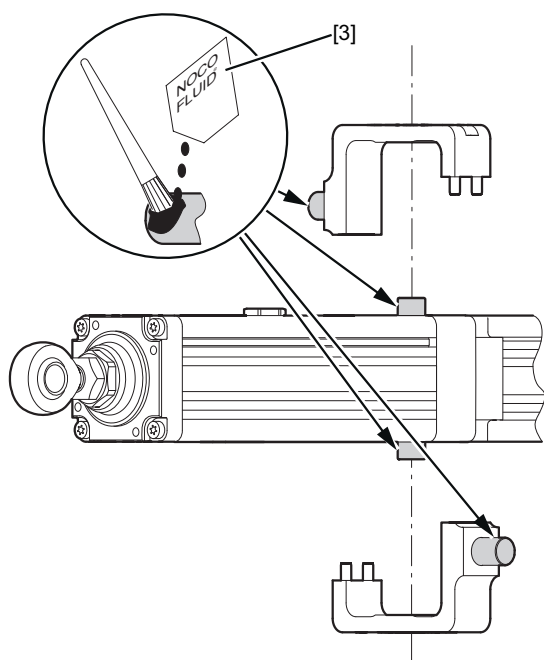

1. Apply NOCO® fluid [3] to the pins.

22858352779

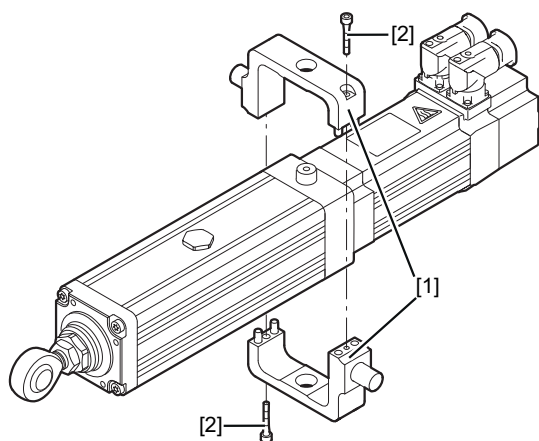

22858355211

1. Place the cardan joint [1] on the pins of the electric cylinder.
2. Fasten the cardan joint [1] with the 2 cap screws [2].
3. Tighten the 2 cap screws [2] according to the motor size with the tightening torque from the table below.

Tightening torques cap screws [2]

Motor size	Tightening torques ¹⁾
CMS(M)B50	6.5 Nm
CMS(M)B63	11.3 Nm
CMS(M)B71	27.3 Nm

1) Values $\pm 20\%$

1.2 KDC, FKDC design (mounted to C-side)**INFORMATION**

Observe the following notes when installing this design of the cardan joint:

- Installation of the electric cylinder in this design is only permitted for the vertical mounting positions M2 and M4.
- This design cannot be used in combination with CMSMB.. with axes mounted in parallel (AP). Under certain conditions, application is possible in cases with low working stroke. Contact SEW-EURODRIVE in such cases.

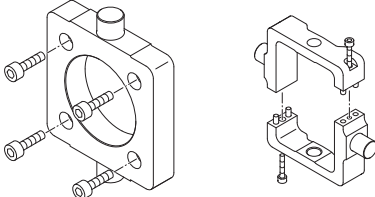
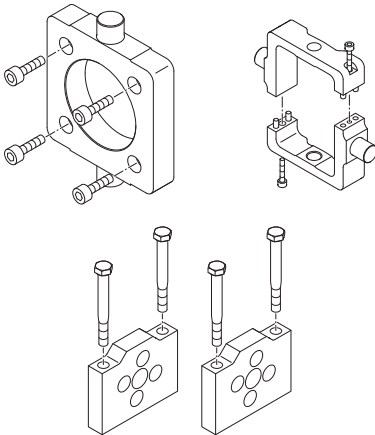
Design	Figure
KDC Cardan joint	 24004341387
FKDC Cardan joint including flange mounting kit	 24004345739

1.2.1 Mounting kit

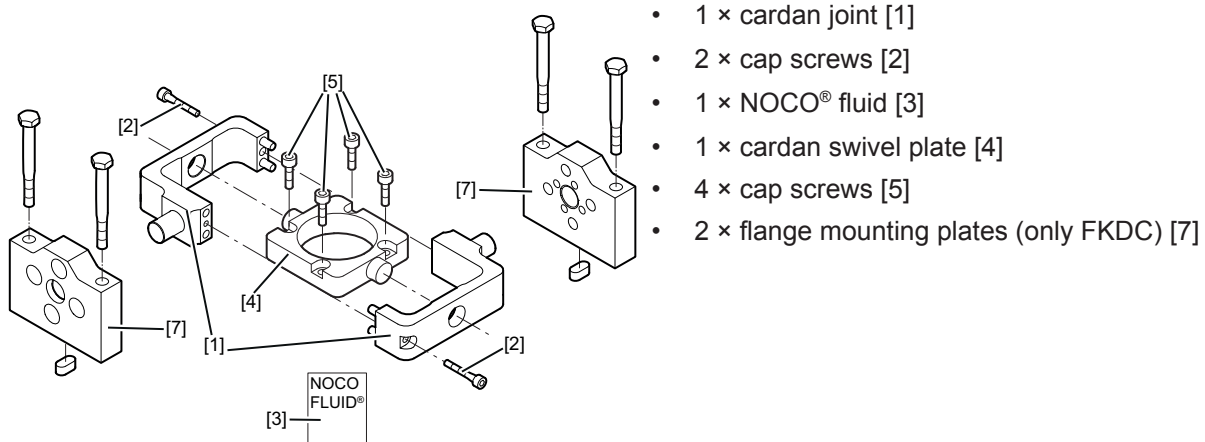

22860884747

1.2.2 Assembly



⚠ WARNING

Unintended movement may occur during assembly and disassembly due to the shift of the electric cylinder's center of mass.

Serious injuries.

- Provide devices limiting movement in the plant structure.
- Secure the electric cylinder against uncontrolled oscillatory movement.
- Do not use the motor connection cables to limit movement.
- Do not strain the motor connection cables with tensile forces.

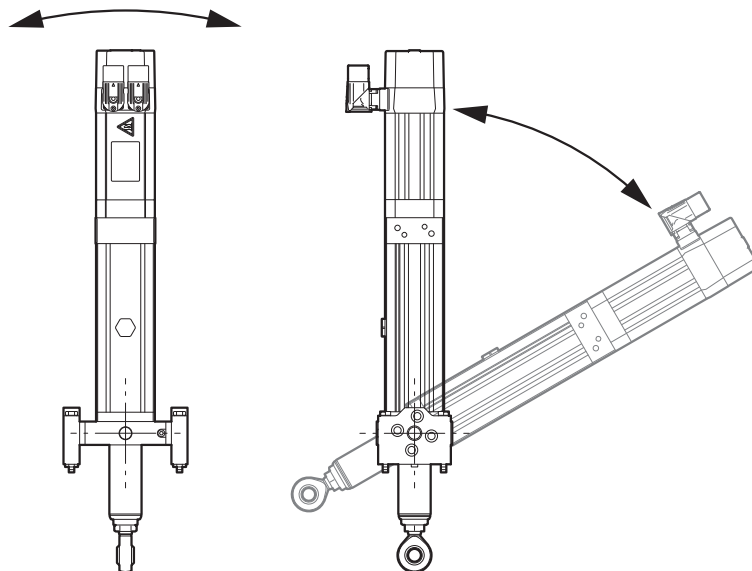

23482063243

Cardan joint assembly

KDC, FKDC design (mounted to C-side)

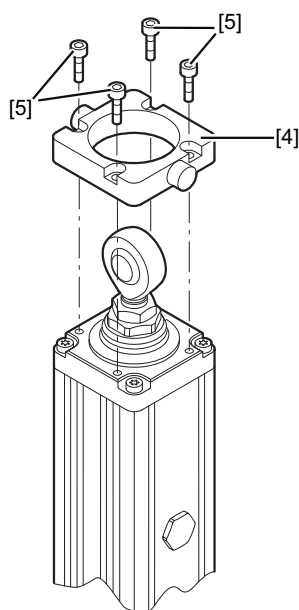

22860887179

1. Place the cardan swivel plate [4] on the mounting surface of the electric cylinder.
2. Fasten the cardan swivel plate [4] with the 4 cap screws [5].
3. Tighten the 4 cap screws [5] according to the motor size with the tightening torque from the table below.

Tightening torques cap screws [5]

Motor size	Tightening torque ¹⁾
CMS(M)B50	11.3 Nm
CMS(M)B63	11.3 Nm
CMS(M)B71	54.0 Nm

1) Values $\pm 20\%$

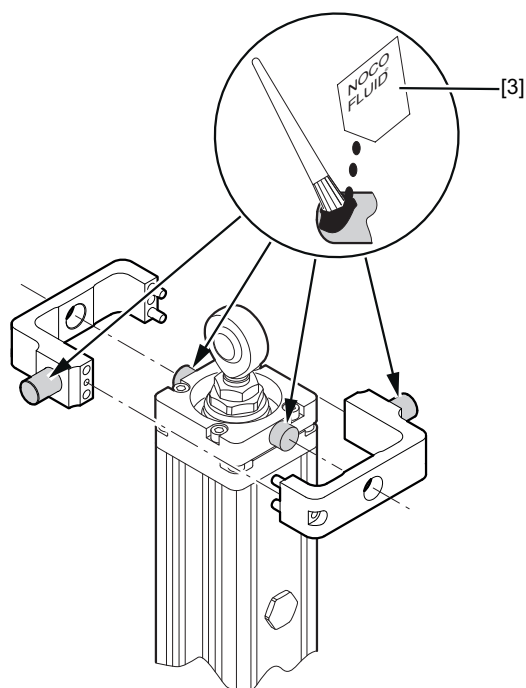

22860889611

1. Apply NOCO® fluid [3] to the pins.

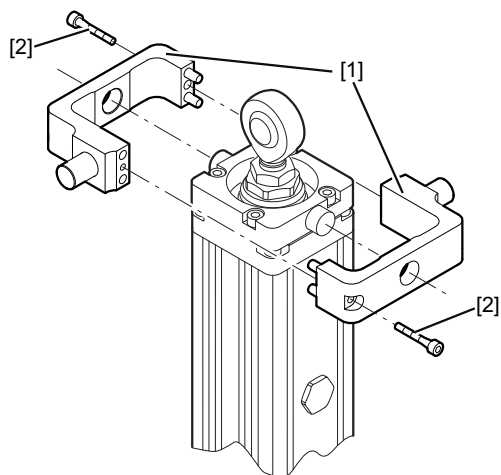

22860892043

1. Place the cardan joint [1] on the pins of the cardan swivel plate.
2. Fasten the cardan joint [1] with the 2 cap screws [2].
3. Tighten the 2 cap screws [2] according to the motor size with the tightening torque from the table below.

Tightening torques cap screws [2]

Motor size	Tightening torques ¹⁾
CMS(M)B50	6.5 Nm
CMS(M)B63	11.3 Nm
CMS(M)B71	27.3 Nm

1) Values $\pm 20\%$







SEW-EURODRIVE
Driving the world

SEW
EURODRIVE

SEW-EURODRIVE GmbH & Co KG
Ernst-Blickle-Str. 42
76646 BRUCHSAL
GERMANY
Tel. +49 7251 75-0
Fax +49 7251 75-1970
sew@sew-eurodrive.com
→ www.sew-eurodrive.com