



**MOVIMOT<sup>®</sup> Retrofit Kit**

**Edition**

*11/2001*

**Addendum to Operating Instructions**

**1053 7910/ EN**



## 1 Important Notes



- This information does not replace the detailed operating instructions!
- Installation should only be performed by qualified personnel in compliance with the applicable accident prevention regulations and the MOVIMOT® Operating Instructions!
- Only the following (brake) motors may be retrofitted:
  - Motor nominal voltage 220 – 240/380 – 415 V<sub>AC</sub>, 50 Hz
  - Brake nominal voltage 230 V<sub>AC</sub> with MM03 – 15  
110 V<sub>AC</sub> with MM22/30
- No retrofit sets are available for UL devices!

Use the following table to verify that you have the correct retrofit set for your motor:

1400 1/min



Power / kW	Motor	+ Retrofit set part number	= MOVIMOT®
0.37	DT71 D4	826 614 X (MM03, $\lambda$ )	DT71 D4/.../MM03
0.55	DT80 K4	826 615 8 (MM05, $\lambda$ )	DT80 K4/.../MM05
0.75	DT80 N4	826 616 6 (MM07, $\lambda$ )	DT80 N4/.../MM07
1.1	DT90 S4	826 617 4 (MM11, $\lambda$ )	DT90 S4/.../MM11
1.5	DT90 L4	826 618 2 (MM15, $\lambda$ )	DT90 L4/.../MM15
2.2	DV100 M4	826 619 0 (MM22, $\lambda$ )	DV100 M4/.../MM22
3.0	DV100 L4	826 620 4 (MM30, $\lambda$ )	DV100 L4/.../MM30

2900 1/min



Power / kW	Motor	+ Retrofit set part number	= MOVIMOT®
0.37	–	–	–
0.55	DT71 D4	826 621 2 (MM05, $\Delta$ )	DT71 D4/.../MM05
0.75	DT80 K4	826 622 0 (MM07, $\Delta$ )	DT80 K4/.../MM07
1.1	DT80 N4	826 623 9 (MM11, $\Delta$ )	DT80 N4/.../MM11
1.5	DT90 S4	826 624 7 (MM15, $\Delta$ )	DT90 S4/.../MM15
2.2	DT90 L4	826 625 5 (MM22, $\Delta$ )	DT90 L4/.../MM22
3.0	DV100 M4	826 626 3 (MM30, $\Delta$ )	DV100 M4/.../MM30



## 2 Scope of Delivery



Use the following illustrations to check the completeness of the scope of delivery.

### Scope of delivery of retrofit set MM03 – MM15

Parts C – I are delivered assembled.

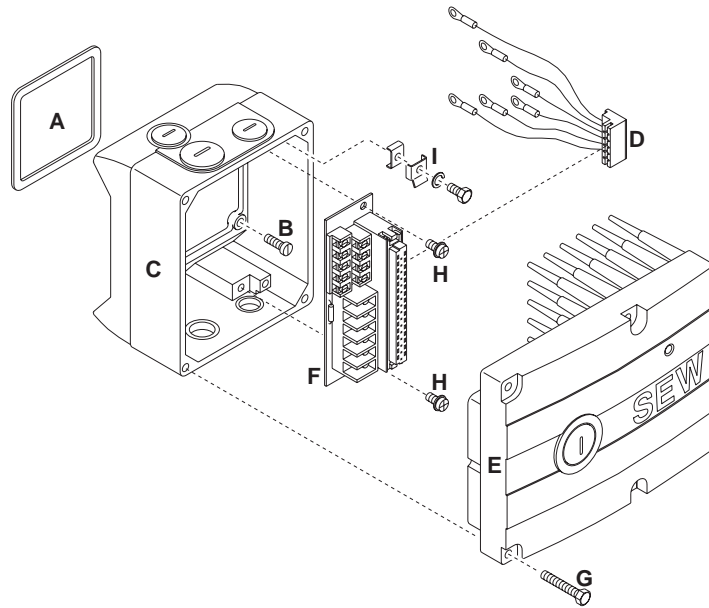

01082DXX

- |                       |  |              |
|-----------------------|--|--------------|
| A Terminal box gasket | D Connection cable with right-angle plug | G Screws (4) |
| B Screws (4)          | E Cover with inverter                    | H Screws (2) |
| C Terminal box        | F Terminal board                         | I PE screw   |

### Scope of delivery of retrofit set MM22 – MM30

Parts C – I are delivered assembled.

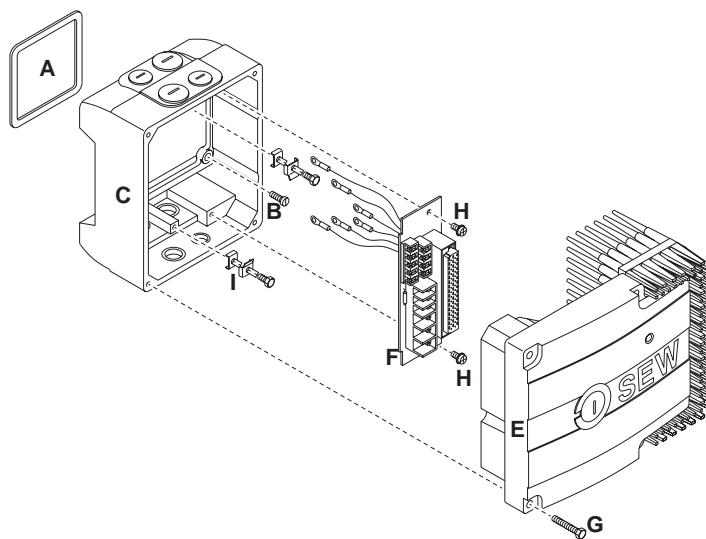

02661BXX

- |                       |  |              |
|-----------------------|--|--------------|
| A Terminal box gasket | E Cover with inverter                  | G Screws (4) |
| B Screws (4)          | F Terminal board with connection cable | H Screws (2) |
| C Terminal box        |  | I PE screw   |



### 3 Assembly

- Remove power supply from motor and prevent unintentional restart
- Remove terminal box cover and power supply cable
- For the result, see the following figure

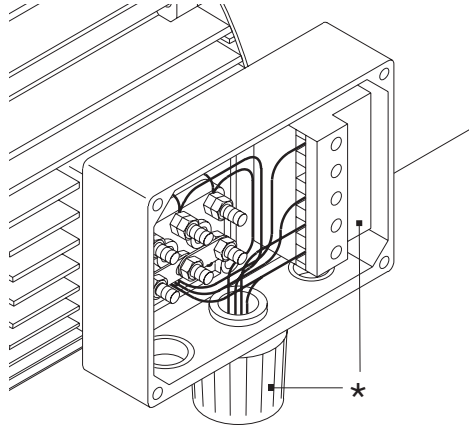

01083BXX

- \* Brake control only with brake motors (optional)

- If brake control is present, remove leads from brake control (1) (2)
- Remove upper nuts (4) and jumpers (3)
- Tighten lower nuts (5)

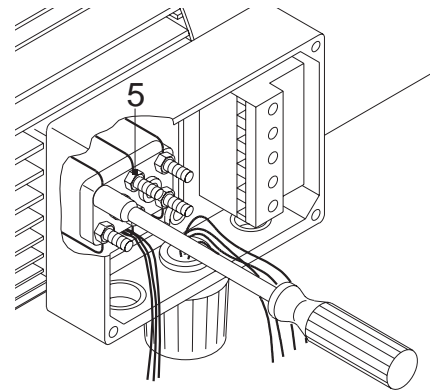
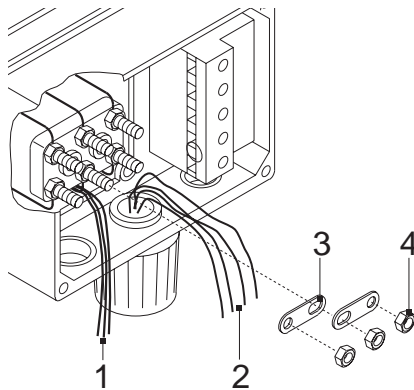

02662BXX



- Remove bottom part of terminal box (6)
- Remove old gasket (7)
- Clean gasket contact surface (8)
- Place new gasket (A) on terminal box (C)

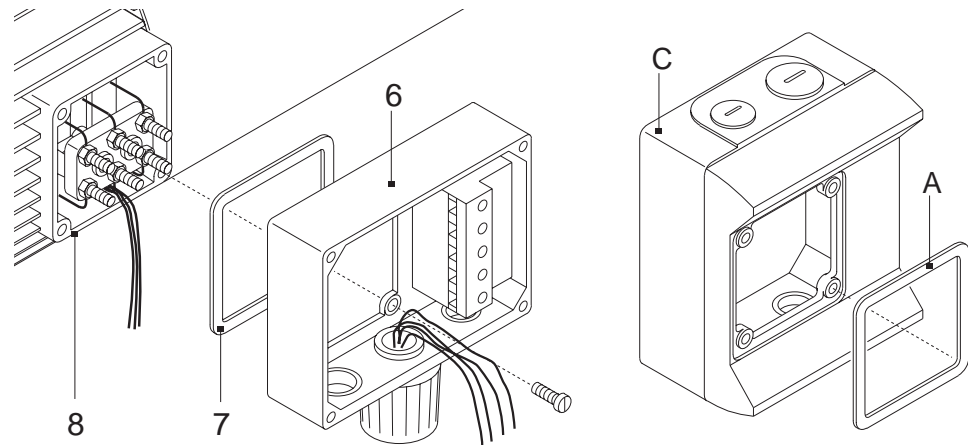

03324AXX

- Mount terminal box (C) and secure with four screws (B).

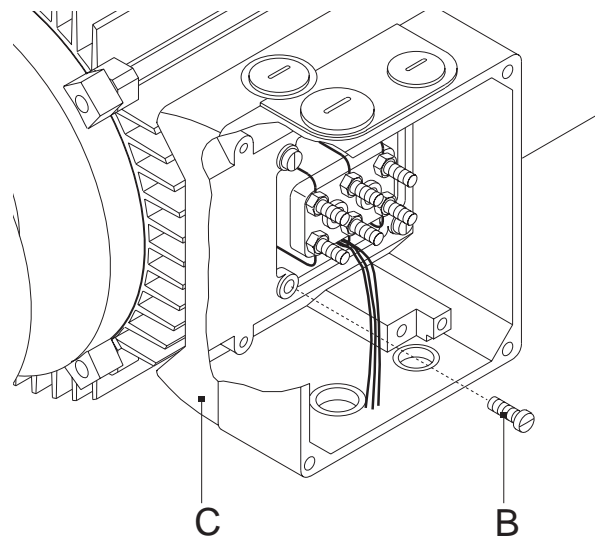

01087DXX



**Caution:** Ensure correct position and placement of gasket (cutout for terminal block on terminal box bottom must point in direction of fan guard)!



### With MOVIMOT® retrofit set MM03 – MM15

- Install right-angle plug harness (D) on terminal studs (9) and tighten nuts.

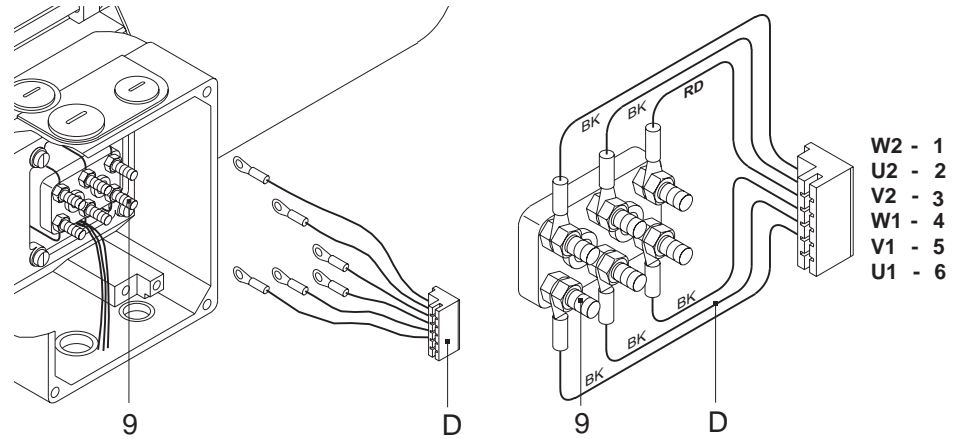

01088FXX

### With MOVIMOT® retrofit set MM22 – MM30

- Install connection cable of terminal board (F) on terminal studs (9) and tighten nuts.

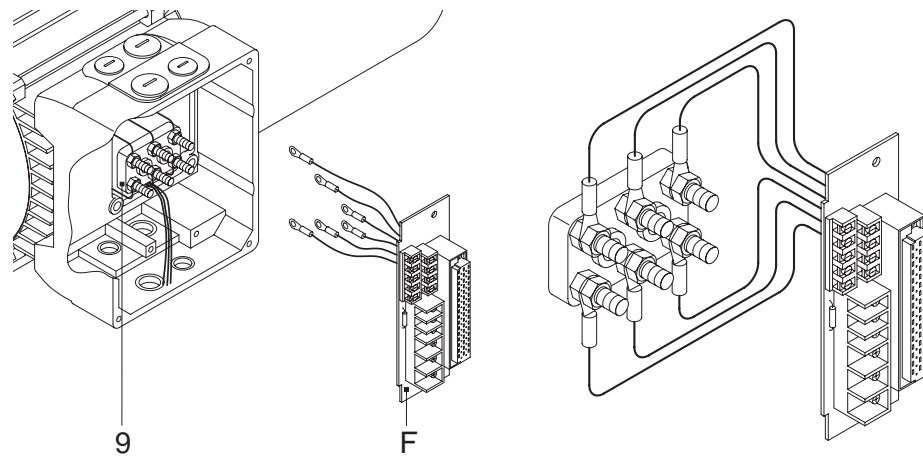

02663BXX



**With MOVIMOT® retrofit set MM03 – MM15**

- Place right-angle plug harness (D) on terminal board (F).
- Position terminal board (F) and secure with two screws (H). **Caution: Do not damage or pinch cable.**

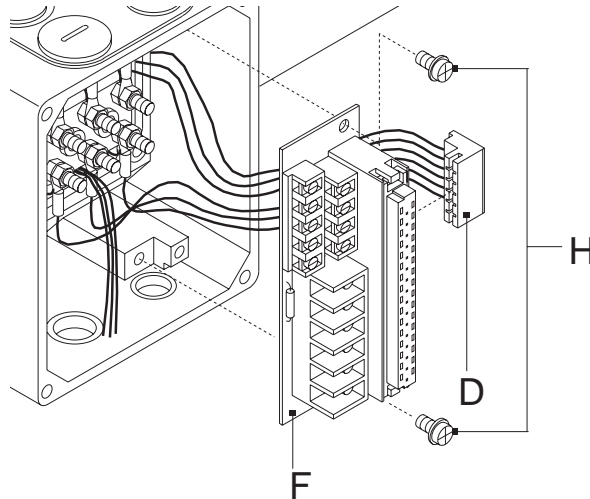

01096DXX

**With MOVIMOT® retrofit set MM22 – MM30**

- Position terminal board (F) and secure with two screws (H). **Caution: Do not damage or pinch cable.**

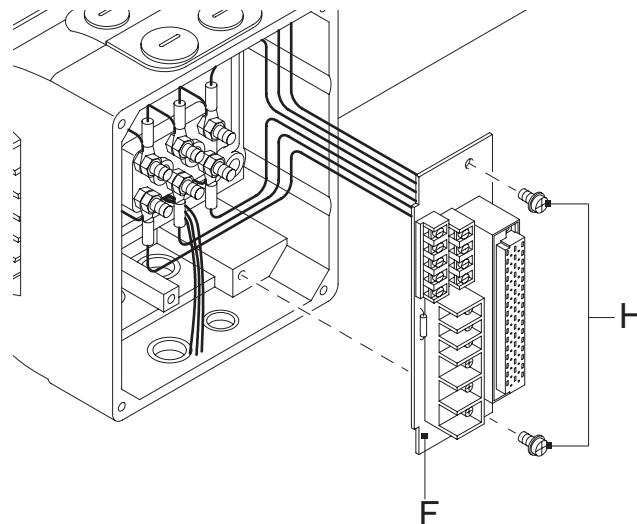

02666BXX



- **Only for brake motors:** Connect brake cable (1).
  - red on terminal X3:13
  - white on terminal X3:14
  - blue on terminal X3:15

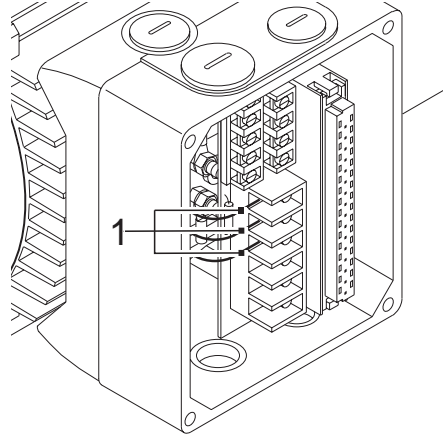

01097DXX